

# energy efficiency module MSE6-E2M-5000-FB35-AGD

Part number: 3870296

FESTO

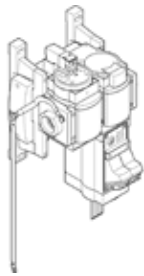

## Data sheet

Feature	Value
Size	6
Series	MSE
Assembly position	Horizontal +/- 5°
Valve function	2/2 open, monostable
Operating pressure	3.5 ... 10 bar
Authorisation	RCM Mark
KC mark	KC-EMV
CE mark (see declaration of conformity)	to EU directive for EMC
Operating medium	Compressed air in accordance with ISO8573-1:2010 [7:4:4]
Note on operating and pilot medium	Lubricated operation not possible
Corrosion resistance classification CRC	2 - Moderate corrosion stress
Storage temperature	-10 ... 60 °C
Medium temperature	0 ... 50 °C
Protection class	IP65 with plug socket
Ambient temperature	0 ... 50 °C
Product weight	3,450 g
Pneumatic connection, port 1	G1/2
Pneumatic connection, port 2	G1/2
Material seals	NBR
Material housing	Aluminium die cast
Material of cover	PA-reinforced
Material cover	PA-reinforced
Fieldbus interface	2x SCRJ push-pull socket, AIDA
Operating voltage range, DC electronics/sensors	18 ... 30 V
DC operating voltage, load voltage	18 ... 26.4 V
Polarity protected	For operating voltage connections
Unit(s) that can be displayed	kPa l l/min m3 mbar psi scf scfm
Flow measurement range initial value	50 l/min
Flow measurement range final value	5,000 l/min
Accuracy of flow rate	± (3% o.m.v. + 0,3% FS)
Pressure measuring range, initial value	0 bar
Pressure measuring range, final value	14 bar
Accuracy, FS	3 %FS